

# SHOCK ABSORBER

AIR TYPE - 3 ~ 5 INCH

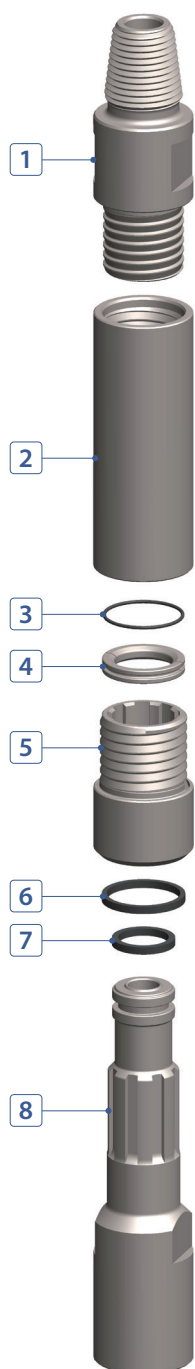

## 3" SHOCK ABSORBER

No.	DESCRIPTION	Q'TY	PART #
1	Upper Adapter	1	S030-03-C01ARP
2	Tube	1	S030-03-C04000
3	Shaft Stop Ring O-Ring	1	S030-03-C10000
4	Shaft Stop Ring	1	S030-03-C09000
5	Drive Sub	1	S030-03-C12000
6	Drive Sub Seal	1	S030-03-C13000
7	Shaft Seal	1	S030-03-C14000
8	Shaft	1	S030-03-C15ARB

## 4" SHOCK ABSORBER

No.	DESCRIPTION	Q'TY	PART #
1	Upper Adapter	1	S040-03-C01ARP
2	Tube	1	S040-03-C04000
3	Shaft Stop Ring O-Ring	1	S040-03-C10000
4	Shaft Stop Ring	1	S040-03-C09000
5	Drive Sub	1	S040-03-C12000
6	Drive Sub Seal	1	S040-03-C13000
7	Shaft Seal	1	S040-03-C14000
8	Shaft	1	S040-03-C15ARB

## 5" SHOCK ABSORBER

No.	DESCRIPTION	Q'TY	PART #
1	Upper Adapter	1	S050-03-C01CRP
2	Tube	1	S050-03-C04000
3	Shaft Stop Ring O-Ring	1	S050-03-C10000
4	Shaft Stop Ring	1	S050-03-C09000
5	Drive Sub	1	S050-03-C12000
6	Drive Sub Seal	1	S050-03-C13000
7	Shaft Seal	1	S050-03-C14000
8	Shaft	1	S050-03-C15CRB

## SHOCK ABSORBER SPECIFICATIONS

Size	3"		4"		5"	
Length	21.5"	547 mm	22.2"	565 mm	30.6"	777 mm
Outside Diameter	3.12"	79.2 mm	3.74"	95 mm	4.52"	115 mm
Weight	33 lbs.	15 kg	55 lbs.	25 kg	103.4 lbs.	47 kg
Connection	Std. 2-3/8" API Reg		Std. 2-3/8" API Reg		Std. 3-1/2" API Reg	